

Corner Radius

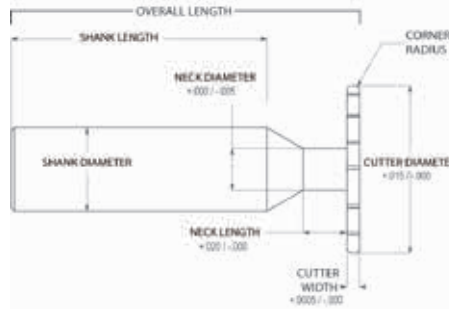
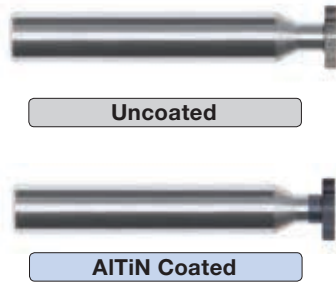

Corner Radius Carbide Head Key Cutters with Steel Shank

Cutter ø	Cutter Width	Neck ø	Neck Length	# of Teeth	Shank Length	Corner Radius	Depth of Cut	OAL	Shank ø	Uncoated Part #	AlTiN Coated Part #
1-1/4	.0625 (1/16)	.280	1/4	14	2-3/4	.005	.485	3.063	1/2	RKC1021310	RKC1021310A
	.0625 (1/16)	.280	1/4	14	2-3/4	.010	.485	3.063	1/2	RKC1021320	RKC1021320A
	.0625 (1/16)	.280	1/4	14	2-3/4	.015	.485	3.063	1/2	RKC1021330	RKC1021330A
	.0938 (3/32)	.280	1/4	14	2-3/4	.005	.485	3.094	1/2	RKC1021340	RKC1021340A
	.0938 (3/32)	.280	1/4	14	2-3/4	.010	.485	3.094	1/2	RKC1021350	RKC1021350A
	.0938 (3/32)	.280	1/4	14	2-3/4	.015	.485	3.094	1/2	RKC1021360	RKC1021360A
	.1250 (1/8)	.280	1/4	14	2-3/4	.005	.485	3.125	1/2	RKC1021370	RKC1021370A
	.1250 (1/8)	.280	1/4	14	2-3/4	.010	.485	3.125	1/2	RKC1021380	RKC1021380A
	.1250 (1/8)	.280	1/4	14	2-3/4	.015	.485	3.125	1/2	RKC1021390	RKC1021390A
	.1250 (1/8)	.280	1/4	14	2-3/4	.030	.485	3.125	1/2	RKC1021400	RKC1021400A
	.2500 (1/4)	.380	1/4	14	2-3/4	.005	.435	3.250	1/2	RKC1021410	RKC1021410A
	.2500 (1/4)	.380	1/4	14	2-3/4	.010	.435	3.250	1/2	RKC1021420	RKC1021420A
	.2500 (1/4)	.380	1/4	14	2-3/4	.015	.435	3.250	1/2	RKC1021430	RKC1021430A
.2500 (1/4)	.380	1/4	14	2-3/4	.030	.435	3.250	1/2	RKC1021440	RKC1021440A	

Key Cutters